

PowerAlert Console Launcher

To address Java Runtime Environment (JRE) issues with respect to the SNMPWEBCARD web interface, Tripp Lite recommends using the PowerAlert Console Launcher. This application enables local access of the SNMPWEBCARD interface using a self-contained, compatible JRE version. The Console Launcher can be downloaded for free from the Technical Support page or from the Management Solutions / Utilities page.

7.4kW Single-Phase Monitored PDU, LX Interface, 230V Outlets (36 C13/6 C19), IEC 309 32A Blue, 10 ft. Cord, 0U 1.8m/70 in. Height, TAA

MODEL NUMBER: PDUMNV32HV2LX

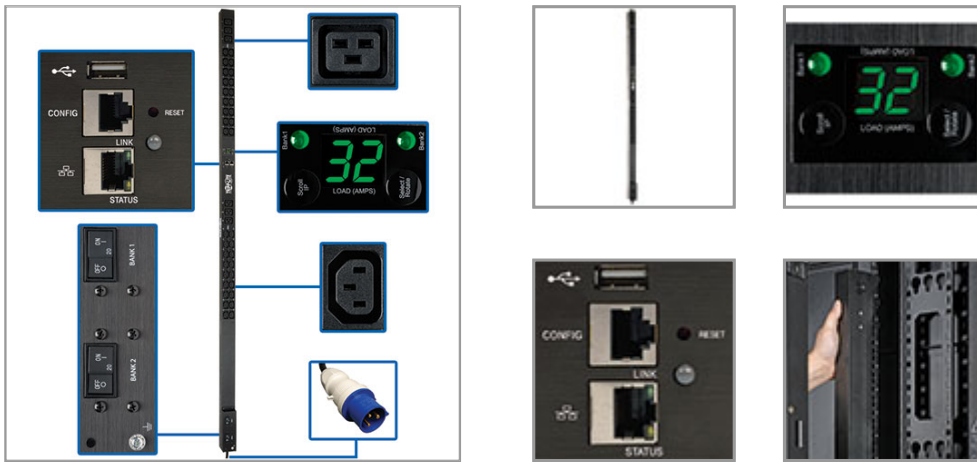

Description

The PDUMNV32HV2LX 7.4kW Single-Phase Monitored PDU provides real-time remote monitoring of voltage, frequency and load levels via built-in network connection. By reducing the frequency of on-site visits, these advanced remote capabilities can save you money and reduce downtime.

The 0U PDU features 42 outlets (36 C13 and 6 C19) with included plug-lock insert sleeves to prevent cables from becoming accidentally disconnected. A 10-foot cord with IEC 309 32A Blue (2P+E) plug connects the PDU to a compatible AC power source, generator or protected UPS.

The built-in Java-free HTML5-based LX Platform network interface enables full remote access for PDU status monitoring and email notifications via secure web browser, SNMP, telnet or SSH. It supports 10/100 Mbps auto-sensing for optimum communication with an Ethernet network. Optional EnviroSense2 modules (sold separately) provide a variety of environmental monitoring capabilities. Protocols supported include IPv4, IPv6, HTTP, HTTPS, SMTP, SNMPv1, SNMPv2, SNMPv3, telnet, SSH, FTP, DHCP and NTP.

A digital ammeter allows you to monitor each load bank's current and the total connected PDU load in real time to ensure they remain well below maximum capacity with no danger of overload. The PDU mounts in 0U of space in EIA-standard 19-inch racks using the included toolless mounting buttons or the included rack-mounting brackets. Use the included PDUMVROTATEBRKT kit to install the unit with outlets facing

Highlights

- 7.4kW 230V single-phase monitored 0U PDU
- 42 outlets—36 C13, 6 C19—with plug-lock insert sleeves
- Built-in Java-free LX Platform interface for remote access 24/7
- Digital ammeter for on-site load monitoring in real time
- IEC 309 32A Blue (2P+E) input with 10 ft. AC power cord

Package Includes

- PDUMNV32HV2LX 7.4kW Single-Phase Monitored PDU
- Built-in LX Platform interface
- Configuration cable
- (42) Plug-lock insert sleeves
- Rack-mounting hardware
- PDUMVROTATEBRKT mounting bracket accessory
- Owner's manual

the rear for better airflow or equipment access.

Features

Distributes and Monitors Network-Grade Single-Phase Power

- 7.4kW 230V monitored PDU with single-phase input
- IEC 309 32A Blue (2P+E) plug with 10 ft. cord connects to compatible AC power source
- Firmware upgrades support future product enhancements

42 Outlets Distribute AC Power

- 36 C13 and 6 C19 outlets split into 2 separately breakered 20A load banks
- Plug-lock insert sleeves prevent cables from becoming accidentally disconnected

Digital Ammeter

- Reports current for each load bank and total connected PDU load
- Supports IP-address self-ID
- Rotates 180° for easy reading at either angle

Built-In LX Platform Interface

- Allows full remote access for power monitoring with email notifications via secure web browser, SNMP, telnet or SSH
- Supports 10/100 Mbps auto-sensing for communication with an Ethernet network
- Optional EnviroSense2 modules (sold separately) provide a variety of environmental monitoring capabilities
- No Java required

Broad Communications Compatibility

- Supports IPv4, IPv6, HTTP, HTTPS, SMTP, SNMPv1, SNMPv2, SNMPv3, telnet, SSH, FTP, DHCP and NTP
- Supports automatic and manual assignment of IP address

Essential Safety Features

- Tiered access allows administrator and guest to log in via web browser
- Immediate alert notifications via email or SNMP traps
- Supports user-specified alarm notification thresholds
- Real-time clock backup maintains day/date even if PDU is unpowered

Easy 0U Installation in EIA-Standard 19 in. Racks

- Mounts vertically using included toolless buttons or rack-mounting brackets
- Included PDUMVROTATEBRKT allows mounting with rear-facing outlets

TAA-Compliant



- Compliant with the Federal Trade Agreements Act (TAA) for GSA Schedule purchases

Specifications

MODEL TEXT	
What Does This Product Do?	7.4kW 0U PDU distributes and monitors single-phase power in an IT or industrial environment. Built-in Java-free network interface helps you remotely monitor load levels to prevent overloads that cause downtime.
OVERVIEW	
PDU Type	Monitored
OUTPUT	
Output Capacity Details	7.7kW (240V), 7.4kW (230V), 7kW (220V), 6.7kW (208V), 6.4kW (200V) / 32A total capacity; 16A max per breakered outlet bank; 16A max per C19 outlet; 10A max per C13 outlet
Frequency Compatibility	50 / 60 Hz
Output Receptacles	(36) C13; (6) C19
Output Nominal Voltage	200; 208; 220; 230; 240
Overload Protection	Two 20A circuit breakers protect 21 outlets each
INPUT	
PDU Input Voltage	200; 208; 220; 230; 240
Recommended Electrical Service	32A 230V
Maximum Input Amps	32
PDU Plug Type	IEC-309 32A BLUE (2P+E)
Input Cord Length (ft.)	10
Input Cord Length (m)	3.05
Input Phase	Single-Phase
USER INTERFACE, ALERTS & CONTROLS	
Front Panel LCD Display	Digital meter reports PDU output current in amps, Scroll IP-address information; Display can be rotated 180 degrees for installation with the input cable at the top
Front Panel LEDs	Front panel LEDs indicate which loading segment the digital LCD current display is reporting; Bank 1 LED indicates the meter is reporting load level for outlets 1-21; Bank 2 LED indicates the meter is reporting load level for outlets 22-42; Both LEDs lighted indicates the meter is reporting load level for all outlets combined
Switches	Press the SCROLL IP button and release to display the configured IP address in 2 digit intervals; Press the SELECT / ROTATE button and release after one second to advance the local display power power consumption for the 3 reported segments: Bank 1, Bank 2 and Banks 1+2; Press the SELECT / ROTATE button and release after two seconds to rotate the display 180 degrees
PHYSICAL	
Shipping Dimensions (hwd / in.)	73.3 x 6.6 x 5.4



Shipping Dimensions (hwd / cm)	186.2 x 16.8 x 13.7
Shipping Weight (lbs.)	15.5
Shipping Weight (kg)	7.0
Unit Dimensions (hwd / in.)	70 x 2.2 x 2.65
Unit Dimensions (hwd / cm)	177.8 x 5.6 x 6.7
Unit Weight (lbs.)	9.7
Unit Weight (kg)	4.40
Material of Construction	Metal
Form Factors Supported	0U vertical rackmount installation supported with included mounting brackets; supports toolless mounting in button-mount compatible racks
PDU Form Factor	0U; Vertical
ENVIRONMENTAL	
Storage Temperature Range	5 to 140F (-15 to 60C)
Relative Humidity	5-95% non-condensing
Operating Elevation (ft.)	0-10,000
Operating Elevation (m)	0-3000
COMMUNICATIONS	
SNMP Compatibility	Includes built-in LX Platform network interface
CERTIFICATIONS	
Certifications	Tested to IEC60950-1: 2005 2nd Edition; EN 60950-1: 2006 (CE), CE Class A (Emissions), RoHS compliant, TAA Compliant
WARRANTY	
Product Warranty Period (Worldwide)	2-year limited warranty

© 2018 Tripp Lite. All rights reserved. All product and company names are trademarks or registered trademarks of their respective holders. Use of them does not imply any affiliation with or endorsement by them. Tripp Lite has a policy of continuous improvement. Specifications are subject to change without notice. Tripp Lite uses primary and third-party agencies to test its products for compliance with standards. See a list of Tripp Lite's testing agencies: <https://www.tripplite.com/products/product-certification-agencies>